

PRODUCT INFORMATION SHEET

Rev. 2024-01-26

Item #

Product #

239B

2300



Plastipak Industries Inc.
1-800-387-7452
www.plastipak.ca

Quality. Service. Innovation.

PRODUCT INFORMATION

Description	1420 ml - 48 US fl.oz Base
Pack size	250
Color	WHITE
Shape	Round
Special feature	Handle
Family	138 mm
Brimful volume	1485 ml / 50.2 US fl. oz

FORMING PROCESS INFORMATION

Forming process	Injection
Material	Food grade PP
Stock colors	White



DECORATION PROCESS INFORMATION

Decoration options	HD Printing
Print area	371 mm x 103 mm 14.6" x 4.1"
Sidewall	

IML or S/S die line Not applicable

COMPATIBLE PRODUCTS

See fit matrix for the 138 mm family

PACKAGING INFORMATION

Box reference #	P6190		
Stacks per box	12		
Parts per stack	10x21+2x20		
Parts box	250		
Stack orientation	Vertical		
Ext. box dims.	Length	607 mm	23.9"
	Width	461 mm	18.1"
	Height	539 mm	21.2"
External box volume	0.15 cu. m.	5.33 cu. ft.	
Full box weight	12.1 kg	26.7 lbs	

PART DRAWING

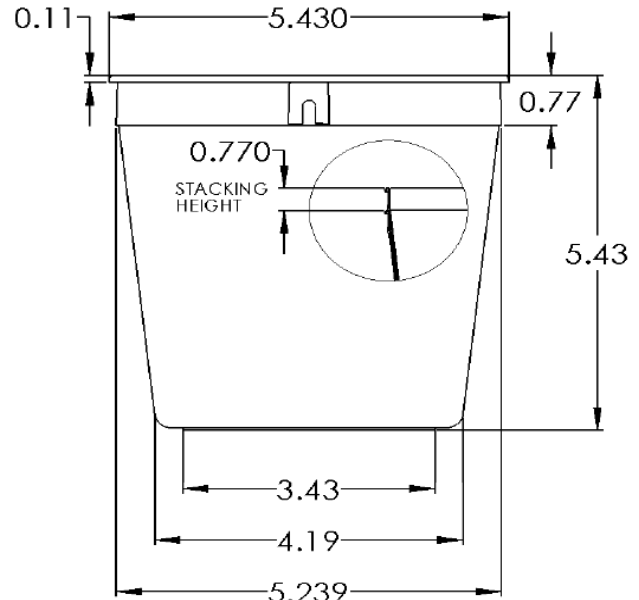

Unit part weight 44.8 g

Notes Dimensional tolerance: +/- 0,01"
Weight tolerance: +/- 3%

OPTIMIZED PALLET CONFIGURATION

Code

C4L

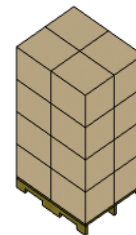

Box / layer	4	Max height	90.4"
Max layers	4	Max Qty	4,000

Layers	Pallet Height in.	Boxes / Pallet	Parts / Pallet
9			
8			
7			
6			
5			
4	90.4	16	4,000
3	69.2	12	3,000
2	47.9	8	2,000