

# PRODUCT INFORMATION SHEET

Rev. 2024-01-16

Item #

Product #

**497A**

**I1050**



Plastipak Industries Inc.  
1-800-387-7452  
www.plastipak.ca

Quality. Service. Innovation.

## PRODUCT INFORMATION

Description	Lid
Pack size	1000
Color	WHITE
Shape	Round
Special feature	Flush
Family	116 mm
Brimful volume	Not applicable

## FORMING PROCESS INFORMATION

Forming process	Injection
Material	Food grade LLDPE
Stock colors	Black, Natural, White



## DECORATION PROCESS INFORMATION

Decoration options	HD Printing
Print area	
Top	Dia. 92 mm Dia. 3.6"
IML or S/S die line	Not applicable

## COMPATIBLE PRODUCTS

See fit matrix for the 116 mm family

## PACKAGING INFORMATION

Box reference #	P6197		
Stacks per box	20		
Parts per stack	50		
Parts box	1000		
Stack orientation	Horizontal		
Ext. box dims.	Length	597 mm	23.5"
	Width	354 mm	13.9"
	Height	492 mm	19.4"
External box volume	0.1 cu. m.	3.67 cu. ft.	
Full box weight	8.4 kg	18.4 lbs	

## PART DRAWING

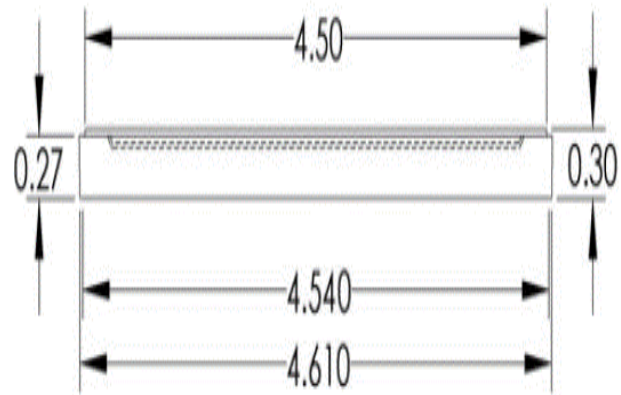

Unit part weight **7.5 g**

Notes Dimensional tolerance: +/- 0,01"  
Weight tolerance: +/- 3%

## OPTIMIZED PALLET CONFIGURATION

Code

**D4L**



Box / layer	<b>5</b>	Max height	<b>83"</b>
Max layers	<b>4</b>	Max Qty	<b>20,000</b>

Layers	Pallet Height in.	Boxes / Pallet	Parts / Pallet
9			
8			
7			
6			
5			
4	83.0	20	20,000
3	63.6	15	15,000
2	44.2	10	10,000